

### **WHB Series- Electric Heat Insert for the AB13 Series - 13 Seer Air Handlers**

The AB13 series - 13 Seer air handlers now have an electric heat insert available. The electric heat insert plugs directly into the wiring harness of the air handler and is easily installed with the removal of two cover plates. The electric heat insert requires no additional controls or wiring and comes equipped with breakers and a high temperature limit. This addition now completes the unitary heat pump line.

#### **What Sizes are Available?**

The electric heat insert is available in 5,10,15, and 20 kW. See AB1324-6000V1M Air Handler Specifications and Performance Guide for air handler and electric heat matching.

#### **Can the AB13 Series Air Handler be ordered with the electric heat factory installed?**

The electric heat insert is field installed only.

#### **How is the Electric Heat Insert field installed?**

1. Remove the cover plates from inside the air handler and the front door.



2. Install the electric heat insert and the breaker holder inside the air handler. Connect the wiring harness.

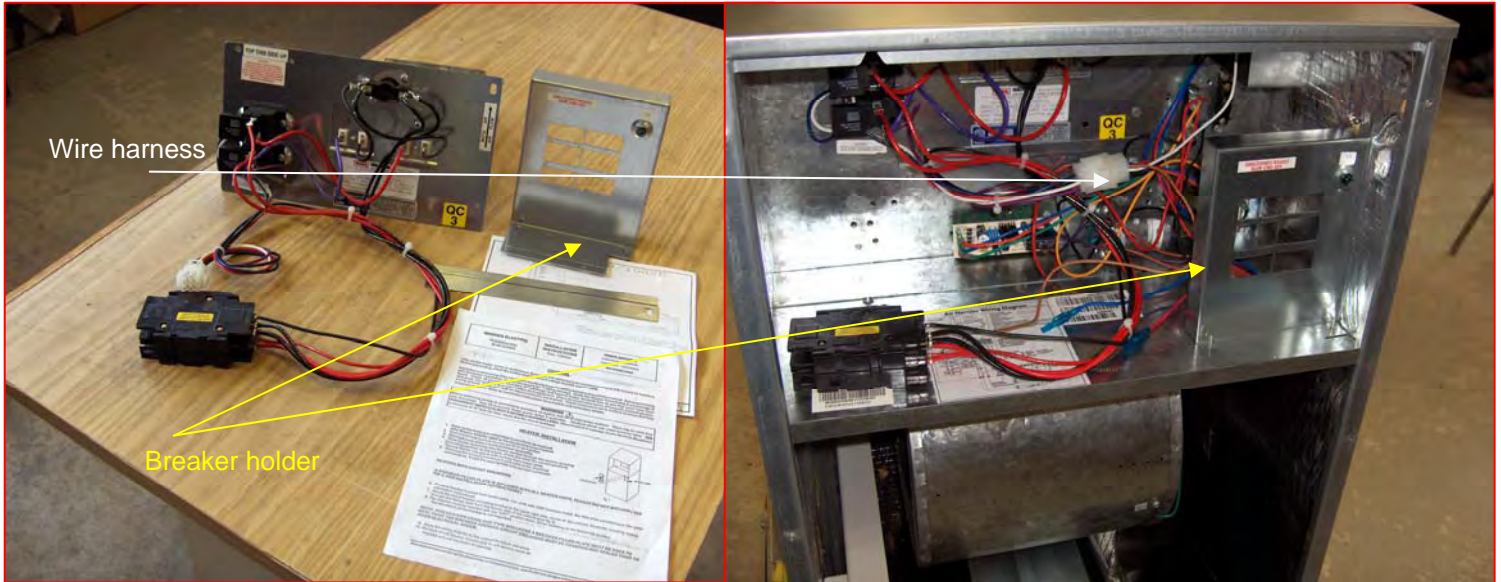

3. Install the breakers, connect power to the breakers and install the front door.



## Model Numbers

<b>H13 Heat Pumps</b>		
<b>Current Part No.</b>	<b>Description</b> (All 208/230V, 60 Hz., Single Phase)	<b>Ship Weight</b>
H13181VARR	1.5 Ton Condensing Unit	167
H13241VARR	2.0 Ton Condensing Unit	203
H13301VARR	2.5 Ton Condensing Unit	207
H13361VARR	3.0 Ton Condensing Unit	220
H13421VARR	3.5 Ton Condensing Unit	258
H13481VARR	4.0 Ton Condensing Unit	271
H13601VARR	5.0 Ton Condensing Unit	315
<b>AB13 Air Handlers</b>		
<b>Current Part No.</b>	<b>Description</b> (4 Way Fully Convertible Air Handlers)	<b>Ship Weight</b>
AB132400V1MR	1.5 - 2.0 Ton Air Handler	141
AB133600V1MR	2.5 - 3.0 Ton Air Handler	181
AB134800V1MR	3.5 - 4.0 Ton Air Handler	196
AB136000V1MR	5.0 Ton Air Handler	205
<b>Air Handler Electric Heat Insert (Field Installed)</b>		
<b>Current Part No.</b>	<b>Description</b>	<b>Ship Weight</b>
WHB0502B-2R	Air Handler Electric Heat Insert-5 kW	10
WHB1002B-2R	Air Handler Electric Heat Insert-10 kW	10
WHB1502B-2R	Air Handler Electric Heat Insert-15 kW	10
WHB2002B-2R	Air Handler Electric Heat Insert-20 kW	10

### **I have additional questions?**

Consult the AB1324-6000V1M Air Handler Specifications and Performance Guide or contact our Technical Service staff at 800-325-5479.

### **Availability**

The WHB Electric Heat Insert is available now.